

# Kulturhaus

## Rasterplan 1.00 / 1.00 m UG Garderobe M. 1 : 100

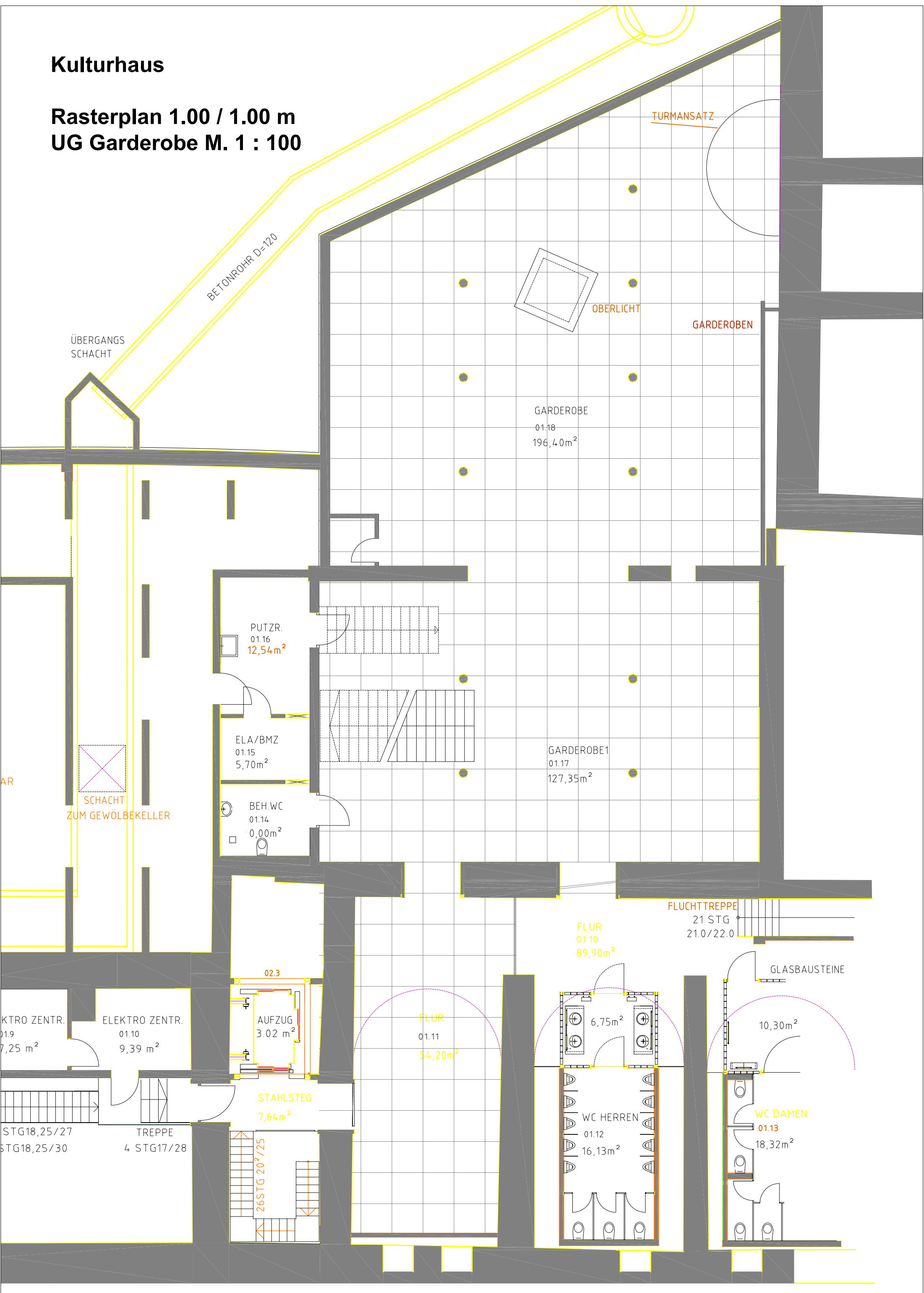

BETONROHR D=120

ÜBERGANGS  
SCHACHT

TURMANSATZ

OBERLICHT

GARDEROBEN

GARDEROBE  
01.18  
196,40m<sup>2</sup>

PUTZR.  
01.16  
12,54m<sup>2</sup>

ELA/BMZ  
01.15  
5,70m<sup>2</sup>

BEH.WC  
01.14  
0,00m<sup>2</sup>

GARDEROBE1  
01.17  
127,35m<sup>2</sup>

FLUCHTTREPPE  
21 STG  
21.0/22.0

FLUR  
01.10  
89,90m<sup>2</sup>

GLASBAUSTEINE

02.3

AUFZUG  
3,02 m<sup>2</sup>

FLUR  
01.11  
54,20m<sup>2</sup>

6,75m<sup>2</sup>

10,30m<sup>2</sup>

ELEKTRO ZENTR.  
01.9  
7,25 m<sup>2</sup>

ELEKTRO ZENTR.  
01.10  
9,39 m<sup>2</sup>

STAHLSTEG  
7,64m<sup>2</sup>

WC HERREN  
01.12  
16,13m<sup>2</sup>

WC DAMEN  
01.13  
18,32m<sup>2</sup>

TREPPE  
4 STG 17/28

26STG 20<sup>2</sup>/25